

blue

MIL SERIES  
DIE & MOULD  
SPOTTING  
PRESSES

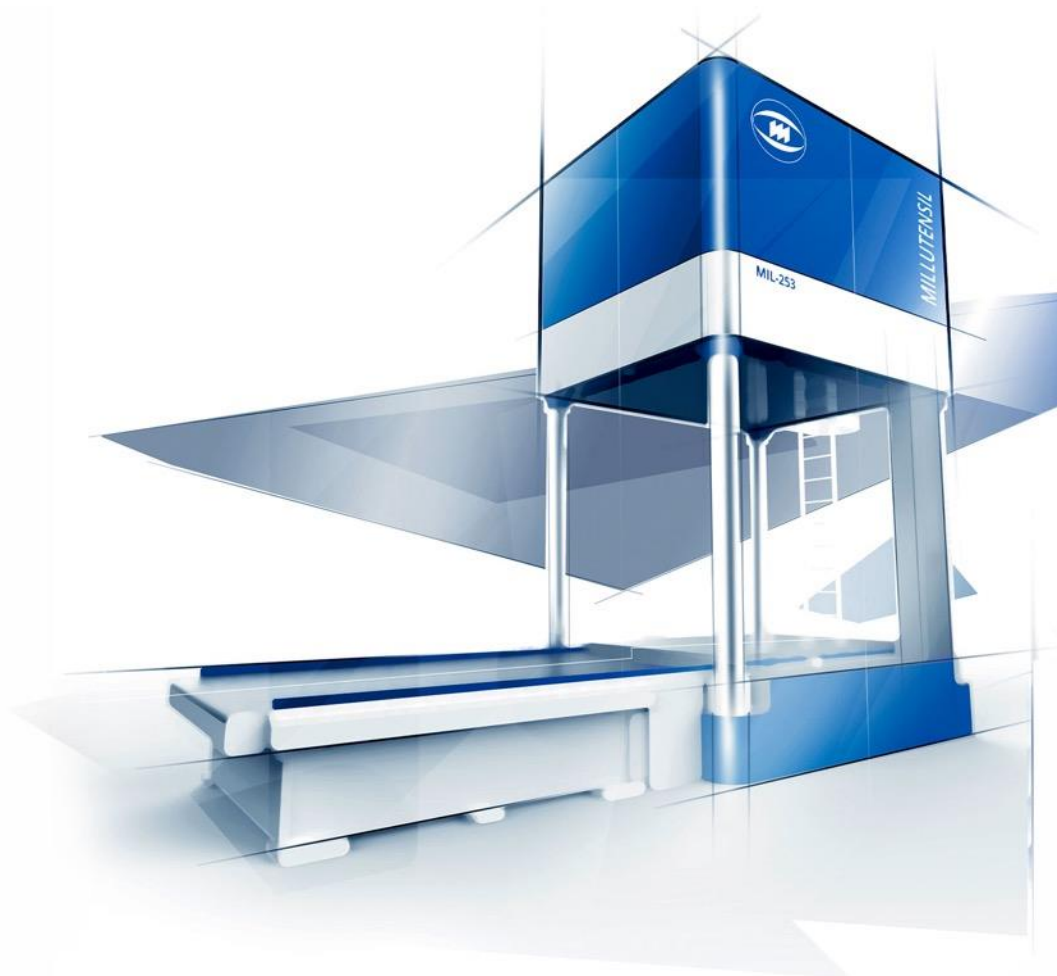

# STANDARD EQUIPMENT

- **ELECTRONIC UPPER PLATE PARALLELISM ANTI-UNBALANCE SAFETY DEVICE, PROTECTION OF PRESS AND MOULDS**

The control system is made of **4 linear magnetic encoders** with decimal precision, located on the external corners of the upper plate, near the columns.

They consist of an **aluminium profile with an IO-Link language and a magnet for reading the position** that runs close to the profile, without touching it.

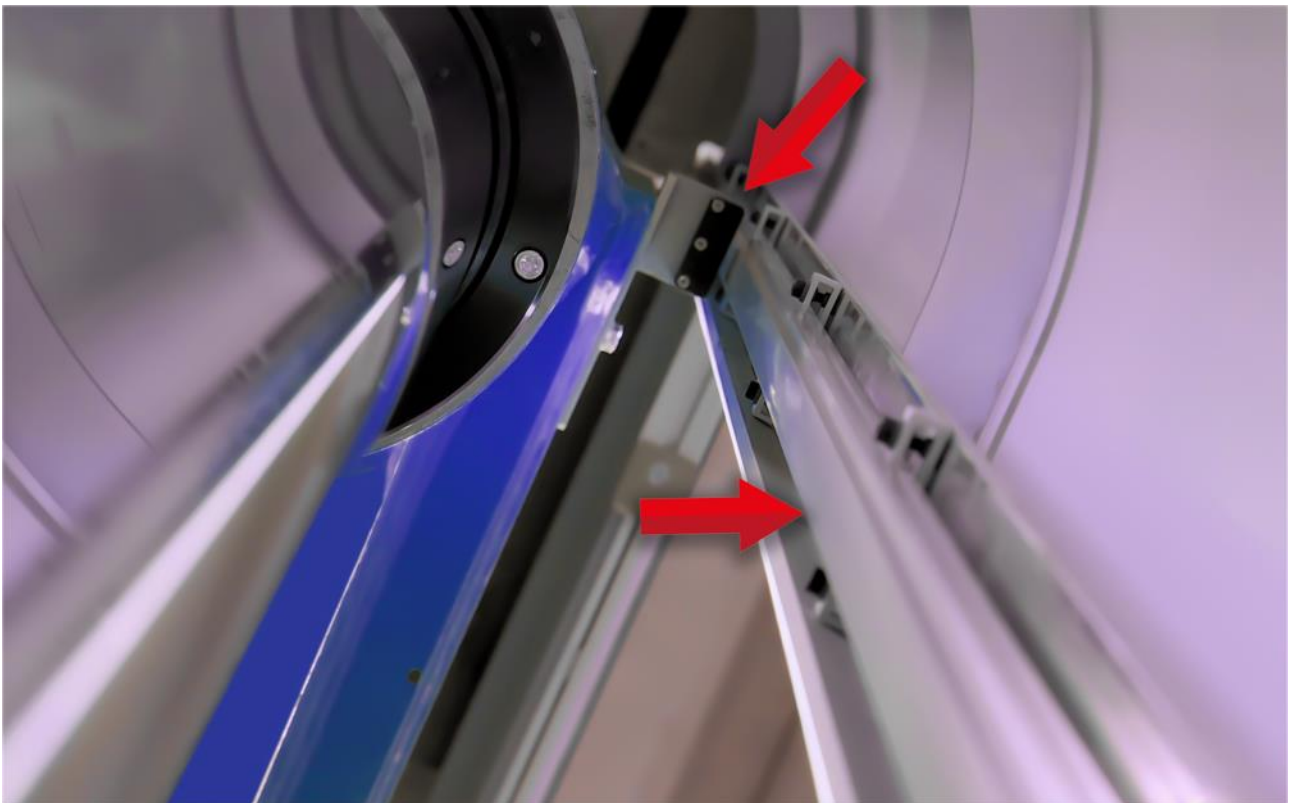

This device is used to **continuously check** the position and the parallelism of the upper plate of the press compared to the lower plate.

The values measured are dynamically displayed on the touch panel for the entire stroke.

The system allows an accuracy level of  $\pm 0.1$  mm.

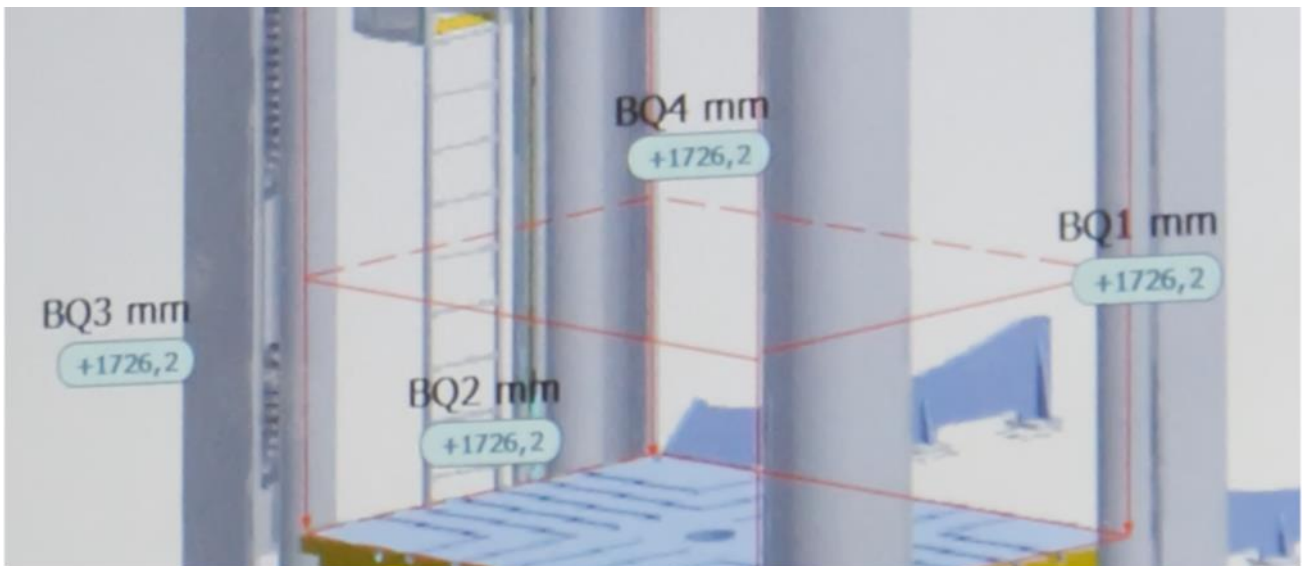

MIL CLASSIC VERSION

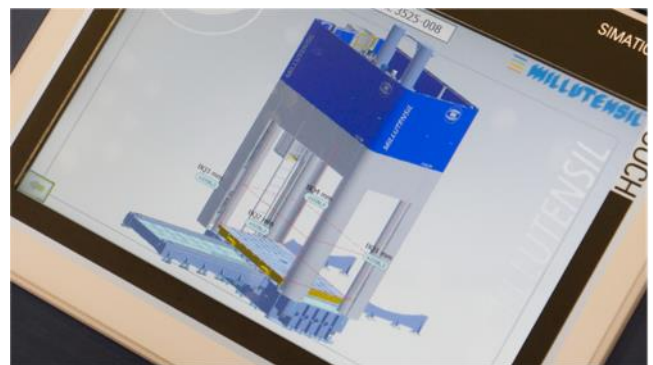

MIL COMPACT VERSION



In addition to parallelism control, the entire functioning of our solution relies on the **accuracy of the lower plate block** thanks to hydraulic half cylinders that precisely fix the entire bottom plate **allowing a perfect alignment of the two halves of the mold**.

#### MIL CLASSIC VERSION

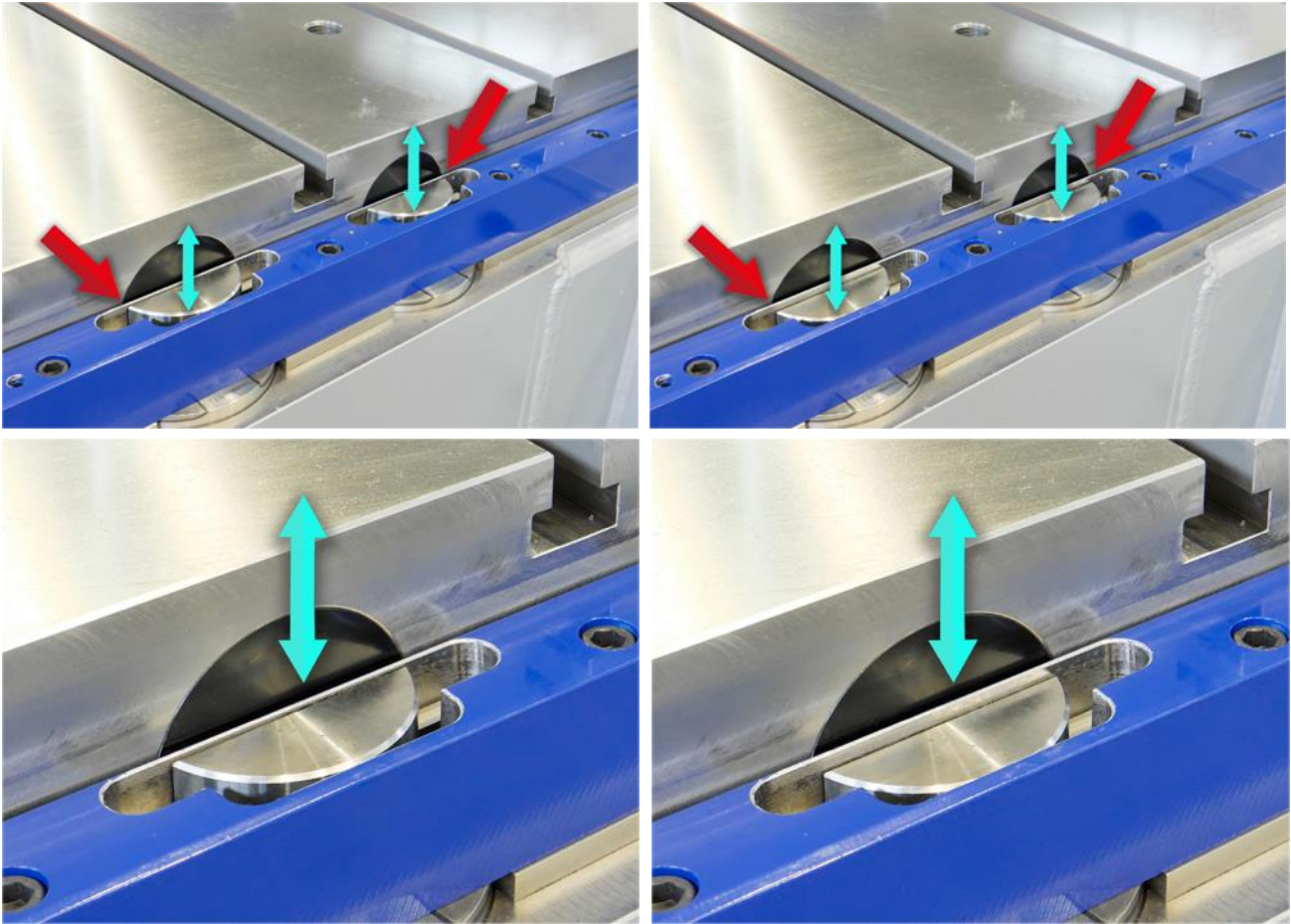

Cylinders up. The lower plate is free to slide.

Cylinders down. The lower plate is locked.

#### MIL COMPACT VERSION



Thanks to this system, both **press and moulds are protected from potential damages**.

## ■ ROLL CARPET PROTECTION DEVICES

**Die & mould spotting presses are equipped with roll carpet protection devices** whose particular feature is that they **can be walked on**.

The design philosophy of Millutensil is aimed at developing solutions that can guarantee **the best ergonomics and highest safety for operators**.

In the MIL classic version, the roll carpet protects the entire sliding plate.

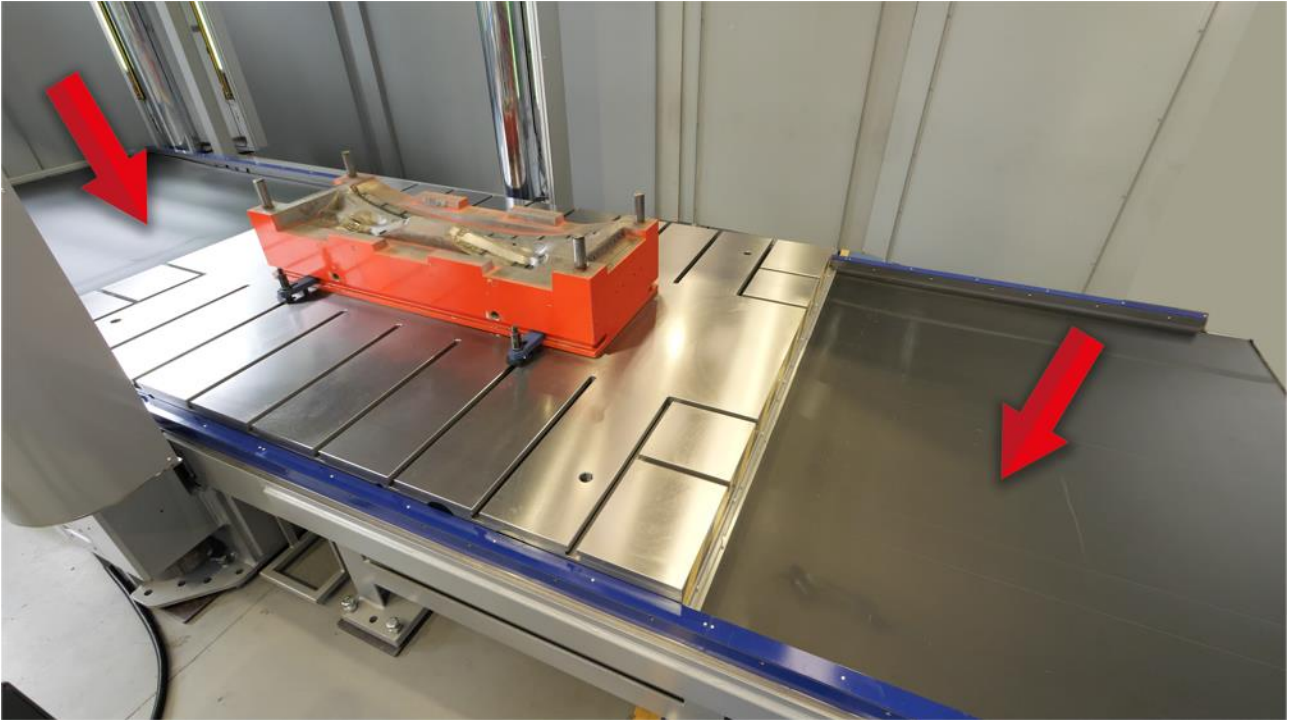

In the MIL compact version, the roll carpet protects the sliding guides.





## ■ DUST COVERS

Die & mould spotting presses are used for final spotting, and the main manual operations that are actually carried out are **adjusting, surfacing and polishing of mould parts**.

For this purpose, Millutensil deems it **fundamental** to equip its presses with **standard dust covers** which represent a high added value because they are very important to **minimise maintenance and to guarantee good operation and accuracy over time**.

